

ORDER FORM SHELL SCHEME PACKAGE

1B

Return to:
Filtech Exhibitions Germany
PO Box 12 25
40637 Meerbusch – Germany
Fax: +49 (0)2132 93 57 62

We hereby order Shell Scheme Package

Cost 120 EURO per sq. m Shell Scheme Stand:

Exhibition space has to be ordered separately, please use form 1A.

These prices are exclusive of VAT – VAT liability is transferred to the recipient of the service according to the reverse charge system. EU VAT Directive 2006/112/EC. VAT will be charged at current rate.

The Shell Scheme Package includes:

STAND CONSTRUCTION

- System material: silver/ white
- Wall elements 1m broad x 2.5 m high, white
- Fascia board (30 cm high), white

FURNISHING

- 1 white counter (50 x 100 cm)
- 1 lockable storage cabin (1 x 1 m)
- 1 table (70 x 70 cm)
- 3 chairs
- 1 waste paper basket
- 1 coat rack
- 1 carpet fair rips grey or blue

ELECTRICAL INSTALLATION

- 3 pcs spotlights (120 W) per 12 sq m
- 3.3 kW main terminal with 1 socket
- Including standard consumption

LETTERING

- Fascia board with 15 characters
- Arial black

STAND CLEANING

- Stand cleaning before opening
- Stand cleaning on the 1st and 2nd evening of the show

Please complete:

Facia text (included)

Carpet colour grey / blue

Company logo on fascia board (80 EURO each side).

Please e-mail your logo in a printable format to info@filtech.de (reference: Facia logo + Company name).

Authorized signature and Company stamp

We have read the conditions and regulations and agree to be bound by them. The Organiser will confirm the application upon receipt.

Company Name _____

VAT Registration No. _____
compulsory for EU registered companies only

Street/PO Box _____

Post Code/City _____

Country _____

Contact Person _____

E-mail _____

Phone _____

Fax _____



Additional furniture, services & electrical installations can be ordered separately.

Additional lettering (2 EURO each letter)



Product Index

1C

Company Name

Stand No/

Page 1

Return all 3 pages to:

Filtech Exhibitions Germany
PO Box 12 25
40637 Meerbusch – Germany
Fax: +49 (0)2132 93 57 62

Street/PO Box

Post Code/City

Country

Contact Person

E-mail

Phone/Fax

Please repeat our 2011 Product Index Entry

Max. 24 keywords for each exhibitor.

FREE SERVICE

- | | | | |
|--|--|--|--|
| <input type="checkbox"/> Absorption Filters | <input type="checkbox"/> Absorptionsfilter | <input type="checkbox"/> Dewatering Equipment | <input type="checkbox"/> Entwässerungsanlagen |
| <input type="checkbox"/> Activated Carbon | <input type="checkbox"/> Aktivkohle | <input type="checkbox"/> Diatomite | <input type="checkbox"/> Kieselgur |
| <input type="checkbox"/> Activated Carbon Media | <input type="checkbox"/> Aktivkohle Medien | <input type="checkbox"/> Disc Filters | <input type="checkbox"/> Scheibenfilter |
| <input type="checkbox"/> Activated Carbon Pleaters | <input type="checkbox"/> Aktivkohle Filteranlagen | <input type="checkbox"/> Disposable Filters | <input type="checkbox"/> Einwegfilter |
| <input type="checkbox"/> Adhesives | <input type="checkbox"/> Klebstoffe | <input type="checkbox"/> Distillation | <input type="checkbox"/> Destillation |
| <input type="checkbox"/> Adhesive Application Systems | <input type="checkbox"/> Klebstoffauftragsysteme | <input type="checkbox"/> Drinking Water Filters | <input type="checkbox"/> Trinkwasserfilter |
| <input type="checkbox"/> Adhesive Application for Filters | <input type="checkbox"/> Filterverklebung | <input type="checkbox"/> Droplet Generators | <input type="checkbox"/> Tröpfchengeneratoren |
| <input type="checkbox"/> Adhesive Dispensers | <input type="checkbox"/> Klebstoffspender | <input type="checkbox"/> Drum Filters | <input type="checkbox"/> Trommelfilter |
| <input type="checkbox"/> Adsorption Filters | <input type="checkbox"/> Adsorptionsfilter | <input type="checkbox"/> Dryers | <input type="checkbox"/> Trockner |
| <input type="checkbox"/> Aeration Systems | <input type="checkbox"/> Belüftungssysteme | <input type="checkbox"/> Dust Collectors | <input type="checkbox"/> Staubabscheider |
| <input type="checkbox"/> Aerosol Generators | <input type="checkbox"/> Aerosolgeneratoren | <input type="checkbox"/> Dust Generators | <input type="checkbox"/> Staubgeneratoren |
| <input type="checkbox"/> Air Dryers | <input type="checkbox"/> Lufttrockner | <input type="checkbox"/> Dust Measuring Systems | <input type="checkbox"/> Staubmessgeräte |
| <input type="checkbox"/> Air Filter Media | <input type="checkbox"/> Luftfiltermedien | <input type="checkbox"/> Dust/Mist Filters | <input type="checkbox"/> Staub-/Tropfenfilter |
| <input type="checkbox"/> Air Filters | <input type="checkbox"/> Luftfilter | <input type="checkbox"/> Edge Element Filters | <input type="checkbox"/> Kantenelementfilter |
| <input type="checkbox"/> Air Flow Meters | <input type="checkbox"/> Luftstrommesser | <input type="checkbox"/> Effluent Filters | <input type="checkbox"/> Abwasserfilter |
| <input type="checkbox"/> Analytical Instruments | <input type="checkbox"/> Analytische Messtechnik | <input type="checkbox"/> Electrocoagulation | <input type="checkbox"/> Elektrokoagulation |
| <input type="checkbox"/> Analytical Centrifuges | <input type="checkbox"/> Analytische Zentrifugen | <input type="checkbox"/> Electrodialysis | <input type="checkbox"/> Elektrodialyse |
| <input type="checkbox"/> Antiscalants | <input type="checkbox"/> Antiscalants | <input type="checkbox"/> Electrical Precipitators | <input type="checkbox"/> elektrische Abscheider |
| <input type="checkbox"/> Automatic Filters | <input type="checkbox"/> Automatische Filter | <input type="checkbox"/> Electrostatic Precipitators | <input type="checkbox"/> electrostatische Abscheider |
| <input type="checkbox"/> Automotive Filters | <input type="checkbox"/> Automobilfilter | <input type="checkbox"/> Expanded Metal | <input type="checkbox"/> Streckmetal |
| <input type="checkbox"/> Bacteriological Filters | <input type="checkbox"/> Bakterienfilter | <input type="checkbox"/> Filter Aids | <input type="checkbox"/> Filterhilfsmittel |
| <input type="checkbox"/> Bag Filters | <input type="checkbox"/> Beutelfilter | <input type="checkbox"/> Filter Bags | <input type="checkbox"/> Filterbeutel |
| <input type="checkbox"/> Back Flush Filters | <input type="checkbox"/> Rückspülfilter | <input type="checkbox"/> Filter Bags from Metal Felt | <input type="checkbox"/> Filterbeutel aus Metallvlies |
| <input type="checkbox"/> Basket Filters (Strainers) | <input type="checkbox"/> Korbfilter | <input type="checkbox"/> Filter Cartridges | <input type="checkbox"/> Filterpatronen |
| <input type="checkbox"/> Battery Separators | <input type="checkbox"/> Batterieseparatoren | <input type="checkbox"/> Filter Centrifuges | <input type="checkbox"/> Filterzentrifugen |
| <input type="checkbox"/> Belt Filters | <input type="checkbox"/> Bandfilter | <input type="checkbox"/> Filter Cloth | <input type="checkbox"/> Filtertücher |
| <input type="checkbox"/> Cabin Air Filters | <input type="checkbox"/> Kabinenfilter | <input type="checkbox"/> Filter Discs | <input type="checkbox"/> Filterscheiben |
| <input type="checkbox"/> Cabin Air Filter Production Lines | <input type="checkbox"/> Kabinenfilter-Produktionslinien | <input type="checkbox"/> Filter Elements | <input type="checkbox"/> Filterelemente |
| <input type="checkbox"/> Candle Filters | <input type="checkbox"/> Kerzenfilter | <input type="checkbox"/> Filter Fabrics | <input type="checkbox"/> Filtergewebe |
| <input type="checkbox"/> Carbon Filters | <input type="checkbox"/> Kohlefilter | <input type="checkbox"/> Filter Felts | <input type="checkbox"/> Filterfilze |
| <input type="checkbox"/> Cartridge Filters | <input type="checkbox"/> Patronenfilter | <input type="checkbox"/> Filter Housings | <input type="checkbox"/> Filtergehäuse |
| <input type="checkbox"/> Centrifuges | <input type="checkbox"/> Zentrifugen | <input type="checkbox"/> Filter Media | <input type="checkbox"/> Filtermedien |
| <input type="checkbox"/> Ceramic Membranes | <input type="checkbox"/> Keramikmembranen | <input type="checkbox"/> Filter Media for Liquids | <input type="checkbox"/> Filtermedien f. Flüssigkeiten |
| <input type="checkbox"/> Ceramic Separators | <input type="checkbox"/> Keramische Separatoren | <input type="checkbox"/> Filter Media for Gases | <input type="checkbox"/> Filtermedien f. Gase |
| <input type="checkbox"/> Chamber Filter Elements | <input type="checkbox"/> Kammerfilterelemente | <input type="checkbox"/> Filter Media Testing | <input type="checkbox"/> Filtermedienprüfung |
| <input type="checkbox"/> Clarifiers | <input type="checkbox"/> Klärer | <input type="checkbox"/> Filter Pads | <input type="checkbox"/> Filterkissen |
| <input type="checkbox"/> Classifiers | <input type="checkbox"/> Klassierer | <input type="checkbox"/> Filter Plates | <input type="checkbox"/> Filterplatten |
| <input type="checkbox"/> Coalescer Media | <input type="checkbox"/> Coalescer Medien | <input type="checkbox"/> Filter Presses | <input type="checkbox"/> Filterpressen |
| <input type="checkbox"/> Coalescers | <input type="checkbox"/> Coalescer | <input type="checkbox"/> Filter Pulp | <input type="checkbox"/> Filterbrei |
| <input type="checkbox"/> Coated Filters, antibacterial | <input type="checkbox"/> Beschichtete Filter, antibakteriell | <input type="checkbox"/> Filter Seaming Machines | <input type="checkbox"/> Filterverschleißmaschinen |
| <input type="checkbox"/> Coolant Filters | <input type="checkbox"/> Kühlmittelfilter | <input type="checkbox"/> Filter Test Rigs (Gas/Air) | <input type="checkbox"/> Filtertesteinrichtungen |
| <input type="checkbox"/> Core Tubes | <input type="checkbox"/> Kernschläuche | <input type="checkbox"/> Filter Textiles | <input type="checkbox"/> Filtertextilien |
| <input type="checkbox"/> Cutting Systems | <input type="checkbox"/> Schneidesysteme | <input type="checkbox"/> Filter Tube End Caps | <input type="checkbox"/> Filterröhrenendkappen |
| <input type="checkbox"/> Cyclones | <input type="checkbox"/> Zyklone | <input type="checkbox"/> Filter Tube Making Machines | <input type="checkbox"/> Filterröhrenmaschine |
| <input type="checkbox"/> Decanters | <input type="checkbox"/> Dekanter, Absetzbecken | <input type="checkbox"/> Filter Tubes | <input type="checkbox"/> Filterröhren, Röhrenfilter |
| <input type="checkbox"/> Dedusters | <input type="checkbox"/> Entstaubungsanlagen | <input type="checkbox"/> Filterability Tester | <input type="checkbox"/> Filtrierbarkeitstester |
| <input type="checkbox"/> Demisters | <input type="checkbox"/> Tropfenabscheider | <input type="checkbox"/> Filtrate Pumps | <input type="checkbox"/> Filtratpumpen |
| <input type="checkbox"/> Deodorization | <input type="checkbox"/> Desodorierung | <input type="checkbox"/> Filtration Plants | <input type="checkbox"/> Filteranlagen |
| <input type="checkbox"/> Desalination | <input type="checkbox"/> Entsalzung | <input type="checkbox"/> Flocculants | <input type="checkbox"/> Flockungsmittel |
| | | <input type="checkbox"/> Flocculation & Mixing Systems | <input type="checkbox"/> Flockungs- u. Mischsysteme |

Product Index

1C Company Name

Stand No/

Page 2

Number of product entries is limited to 24 keywords for each exhibitor.

- | | | | |
|--|---|--|---|
| <input type="checkbox"/> Flotation Equipment | <input type="checkbox"/> Flotationsanlage | <input type="checkbox"/> Nonwovens, Meltblown | <input type="checkbox"/> Vliesmaterialien, Meltblown |
| <input type="checkbox"/> Flow Indicators | <input type="checkbox"/> Durchflußanzeiger | <input type="checkbox"/> Nonwovens, Spunbonded | <input type="checkbox"/> Vliesmaterialien, Spunbonded |
| <input type="checkbox"/> Flow Meters | <input type="checkbox"/> Durchflussmesser | <input type="checkbox"/> Nonwovens, Spunlaced | <input type="checkbox"/> Vliesmaterialien, Spunlaced |
| <input type="checkbox"/> Fluid Samplers | <input type="checkbox"/> Flüssigkeitsprobennehmer | <input type="checkbox"/> Odor Removal | <input type="checkbox"/> Geruchsbereitung |
| <input type="checkbox"/> Fuel Filters | <input type="checkbox"/> Kraftstoff-Filter | <input type="checkbox"/> Oil Filter Media | <input type="checkbox"/> Ölfiltermedien |
| <input type="checkbox"/> Fuel Filter Media | <input type="checkbox"/> Kraftstoff-Filtermedien | <input type="checkbox"/> Oil Filters | <input type="checkbox"/> Ölfilter |
| <input type="checkbox"/> Gas Adsorption | <input type="checkbox"/> Gasadsorption | <input type="checkbox"/> Oil & Fuel Filter Testing | <input type="checkbox"/> Öl- und Benzinfilterprüfung |
| <input type="checkbox"/> Gas Cleaning | <input type="checkbox"/> Gasreinigung | <input type="checkbox"/> Online Particle Analysis | <input type="checkbox"/> Online Partikelanalyse |
| <input type="checkbox"/> Gas Filters | <input type="checkbox"/> Gasfilter | <input type="checkbox"/> Ozone Equipment | <input type="checkbox"/> Ozonanlagen |
| <input type="checkbox"/> Gaskets for Filters | <input type="checkbox"/> Dichtungen für Filter | <input type="checkbox"/> Paint Filters | <input type="checkbox"/> Lackfilter |
| <input type="checkbox"/> Glass Fibre Filter | <input type="checkbox"/> Glasfaserfilter | <input type="checkbox"/> Panel Filter Lines | <input type="checkbox"/> Paneelfilter-Anlagen |
| <input type="checkbox"/> Glass Fibre Media | <input type="checkbox"/> Glasfasermedien | <input type="checkbox"/> Paper Media | <input type="checkbox"/> Papierfiltermittel |
| <input type="checkbox"/> Glass Filter Bags | <input type="checkbox"/> Glasfaserschläuche | <input type="checkbox"/> Particle Counters | <input type="checkbox"/> Partikelzähler |
| <input type="checkbox"/> Heavy-Duty wire mesh pleaters | <input type="checkbox"/> Drahtgewebe-Faltmaschinen | <input type="checkbox"/> Particle Filters for Diesel Engines | <input type="checkbox"/> Dieselrußfilter |
| <input type="checkbox"/> Hepa Filters | <input type="checkbox"/> Hepa-Filter | <input type="checkbox"/> Particle Measuring Methods | <input type="checkbox"/> Partikelanalysemethoden |
| <input type="checkbox"/> Hepa-/Mini Pleating Machines | <input type="checkbox"/> Hepa-/Minipleat Faltmaschine | <input type="checkbox"/> Particle Shape Analysis | <input type="checkbox"/> Partikelformanalyse |
| <input type="checkbox"/> HEPA & ULPA Filter Testing | <input type="checkbox"/> HEPA & ULPA Filterprüfung | <input type="checkbox"/> Particle Size Analysis | <input type="checkbox"/> Partikelgrößenanalyse |
| <input type="checkbox"/> Hot-Gas Filters | <input type="checkbox"/> Heißgasfilter | <input type="checkbox"/> Particle Size Distribution Analysis | <input type="checkbox"/> Partikelgrößenverteilungsanalyse |
| <input type="checkbox"/> Hot-Melt Type Adhesives | <input type="checkbox"/> Schmelzklebstoffe | <input type="checkbox"/> Peeler Centrifuges | <input type="checkbox"/> Schälzentrifugen |
| <input type="checkbox"/> Hot-Melt Type Applications | <input type="checkbox"/> Heißbleimgeräte | <input type="checkbox"/> Perforated Metals | <input type="checkbox"/> Perforierte Metalle |
| <input type="checkbox"/> Humidity Recorders | <input type="checkbox"/> Feuchtigkeitsrecorder | <input type="checkbox"/> Perforation Presses | <input type="checkbox"/> Perforationspressen |
| <input type="checkbox"/> Hydraulic Filters | <input type="checkbox"/> Hydraulikfilter | <input type="checkbox"/> Pervaporation | <input type="checkbox"/> Pervaporation |
| <input type="checkbox"/> Hydraulic Media | <input type="checkbox"/> Hydraulikmedien | <input type="checkbox"/> Pilot plants | <input type="checkbox"/> Pilotanlagen |
| <input type="checkbox"/> Hydrocyclones | <input type="checkbox"/> Hydrozyklone | <input type="checkbox"/> Plasma Treatment | <input type="checkbox"/> Plasma Behandlung |
| <input type="checkbox"/> In-Line Filters | <input type="checkbox"/> Einbaufilter | <input type="checkbox"/> Pleated Filter Cutting Systems | <input type="checkbox"/> Schneidesysteme für Faltfilter |
| <input type="checkbox"/> Intake Filters | <input type="checkbox"/> Ansaugfilter | <input type="checkbox"/> Pleating Machines | <input type="checkbox"/> Faltmaschinen |
| <input type="checkbox"/> Inverting Filter Centrifuges | <input type="checkbox"/> Stülpfilterzentrifugen | <input type="checkbox"/> Pore Size Meter | <input type="checkbox"/> Porengrößenmessgerät |
| <input type="checkbox"/> Ion Exchange System | <input type="checkbox"/> Ionenaustauscheranlage | <input type="checkbox"/> Porous Ceramics | <input type="checkbox"/> Poröse Keramik |
| <input type="checkbox"/> Knife Pleating Machines | <input type="checkbox"/> Messerfaltmaschinen | <input type="checkbox"/> Porous Filter Media | <input type="checkbox"/> Poröse Filtermittel |
| <input type="checkbox"/> Laboratory Filters | <input type="checkbox"/> Laborfilter | <input type="checkbox"/> Porous Metals | <input type="checkbox"/> Poröse Metalle |
| <input type="checkbox"/> Laboratory Mixers | <input type="checkbox"/> Labormischer | <input type="checkbox"/> Porous Plastics | <input type="checkbox"/> Poröse Kunststoffe |
| <input type="checkbox"/> Laboratory Plants | <input type="checkbox"/> Laboranlagen | <input type="checkbox"/> Powders | <input type="checkbox"/> Pulver |
| <input type="checkbox"/> Laboratory Sieves | <input type="checkbox"/> Laborsiebe | <input type="checkbox"/> Powder Classifiers | <input type="checkbox"/> Pulverklassierer |
| <input type="checkbox"/> Laser Diffraction | <input type="checkbox"/> Laserbeugung | <input type="checkbox"/> Pre-Cleaning Filters | <input type="checkbox"/> Vorfilter |
| <input type="checkbox"/> Leaf Filters | <input type="checkbox"/> Blattfilter | <input type="checkbox"/> Precipitators | <input type="checkbox"/> Abscheider |
| <input type="checkbox"/> Lubrication Oil Filters | <input type="checkbox"/> Schmierölfilter | <input type="checkbox"/> Precoat Filters | <input type="checkbox"/> Anschwemmfilter |
| <input type="checkbox"/> Magnetic Filters | <input type="checkbox"/> Magnetfilter | <input type="checkbox"/> Pressure Disc Filters | <input type="checkbox"/> Druckscheibenfilter |
| <input type="checkbox"/> Medical Filters | <input type="checkbox"/> Medizinische Filter | <input type="checkbox"/> Pressure Drum Filters | <input type="checkbox"/> Drucktrommelfilter |
| <input type="checkbox"/> Membrane Bioreactors MBR | <input type="checkbox"/> Membranbioreaktor | <input type="checkbox"/> Pressure Filtration/Dewatering | <input type="checkbox"/> Druckfiltration/
Entwässerung |
| <input type="checkbox"/> Membrane Cleaner | <input type="checkbox"/> Membranreiniger | <input type="checkbox"/> Pressure Leaf Filters | <input type="checkbox"/> Druckblattfilter |
| <input type="checkbox"/> Membrane Manufacturing | <input type="checkbox"/> Membranherstellung | <input type="checkbox"/> Pressure Plate Filters | <input type="checkbox"/> Druckplattenfilter |
| <input type="checkbox"/> Membrane Presses | <input type="checkbox"/> Membranfilterpressen | <input type="checkbox"/> Pretreatment Chemicals | <input type="checkbox"/> Chemikalien f. d. Vorbeh. |
| <input type="checkbox"/> Membranes | <input type="checkbox"/> Membranen | <input type="checkbox"/> Pumps | <input type="checkbox"/> Pumpen |
| <input type="checkbox"/> Membrane Testing Plants | <input type="checkbox"/> Membrantestanlagen | <input type="checkbox"/> Purifiers | <input type="checkbox"/> Reiniger |
| <input type="checkbox"/> Meshes, Metal | <input type="checkbox"/> Maschengewebe, Metal | <input type="checkbox"/> Pusher Centrifuges | <input type="checkbox"/> Schubzentrifugen |
| <input type="checkbox"/> Meshes, Synthetic | <input type="checkbox"/> Maschengewebe, synth. | <input type="checkbox"/> Radial Cartridge | <input type="checkbox"/> Radialfilter |
| <input type="checkbox"/> Metal Cloth | <input type="checkbox"/> Metallgewebe | <input type="checkbox"/> Research plants | <input type="checkbox"/> Forschungsanlagen |
| <input type="checkbox"/> Metal Expander | <input type="checkbox"/> Metallexpander | <input type="checkbox"/> Reusable Filter Media | <input type="checkbox"/> Wiederverw. Filtermedien |
| <input type="checkbox"/> Microfiltration | <input type="checkbox"/> Mikrofiltration | <input type="checkbox"/> Reverse Osmosis | <input type="checkbox"/> Umkehrosmose |
| <input type="checkbox"/> Mist Collectors | <input type="checkbox"/> Dunstabscheider | <input type="checkbox"/> Rotary Membrane Filters | <input type="checkbox"/> Rotierende Membranfilter |
| <input type="checkbox"/> Mist Eliminators | <input type="checkbox"/> Dunstabscheider | <input type="checkbox"/> Rotary Pleaters | <input type="checkbox"/> Rotationsfaltmaschinen |
| <input type="checkbox"/> Multiple Filter Systems | <input type="checkbox"/> Mehrfachfiltersysteme | <input type="checkbox"/> Rotary Vacuum Filters | <input type="checkbox"/> Vakuumdrehfilter |
| <input type="checkbox"/> Multiple Web Pleating Lines | <input type="checkbox"/> Mehrnutzenfaltlinien | <input type="checkbox"/> Rotary Filters | <input type="checkbox"/> Drehfilter |
| <input type="checkbox"/> Nano Media | <input type="checkbox"/> Nanomedien | <input type="checkbox"/> Sampling Equipment | <input type="checkbox"/> Probenahme |
| <input type="checkbox"/> Nanofiltration | <input type="checkbox"/> Nanofiltration | <input type="checkbox"/> Sand Screens | <input type="checkbox"/> Sandsiebe |
| <input type="checkbox"/> Nanoparticle Analysis | <input type="checkbox"/> Nanopartikelanalyse | <input type="checkbox"/> Screen Centrifuges | <input type="checkbox"/> Siebzentrifugen |
| <input type="checkbox"/> Nanoparticle Generation | <input type="checkbox"/> Nanopartikelherstellung | <input type="checkbox"/> Screening Machines | <input type="checkbox"/> Siebmaschinen |
| <input type="checkbox"/> Nanoparticle Measurement | <input type="checkbox"/> Nanopartikelmessung | <input type="checkbox"/> Screw Presses | <input type="checkbox"/> Schneckenpressen |
| <input type="checkbox"/> Nonwovens | <input type="checkbox"/> Vliesmaterialien | <input type="checkbox"/> Sea Water Desalination | <input type="checkbox"/> Meerwasserentsalzung |

Product Index

1C

Company Name

Stand No/

Page 3

Number of product entries is limited to 24 keywords for each exhibitor.

- | | | | |
|--|--|--|---|
| <input type="checkbox"/> Sediment Characterization | <input type="checkbox"/> Sediment Charakterisierung | <input type="checkbox"/> Table Filters | <input type="checkbox"/> Planfilter |
| <input type="checkbox"/> Sedimentation Equipment | <input type="checkbox"/> Sedimentationsanlagen | <input type="checkbox"/> Technical Textiles | <input type="checkbox"/> Technische Textilien |
| <input type="checkbox"/> Self Cleaning Filters | <input type="checkbox"/> Selbstreinigende Filter | <input type="checkbox"/> Test Rigs | <input type="checkbox"/> Testeinrichtung |
| <input type="checkbox"/> Separation Analyser | <input type="checkbox"/> Separationsanalysatoren | <input type="checkbox"/> Thickeners | <input type="checkbox"/> Eindicker |
| <input type="checkbox"/> Separators | <input type="checkbox"/> Abscheider | <input type="checkbox"/> Tower Presses | <input type="checkbox"/> Turmpressen |
| <input type="checkbox"/> Separators - Magnetic | <input type="checkbox"/> Magnetabscheider | <input type="checkbox"/> Tube Filters | <input type="checkbox"/> Röhrenfilter |
| <input type="checkbox"/> Separators - Oil/Mist | <input type="checkbox"/> Abscheider - Öl/Dunst | <input type="checkbox"/> Tube Presses | <input type="checkbox"/> Rohrpressen |
| <input type="checkbox"/> Separators - Oil/Water | <input type="checkbox"/> Abscheider - Öl/Wasser | <input type="checkbox"/> Tube Rolling Machine | <input type="checkbox"/> Rohrwalzmaschine |
| <input type="checkbox"/> Separators - Solid/Liquid | <input type="checkbox"/> Abscheider - Fest/Flüssig | <input type="checkbox"/> Tubular Membrane Modules | <input type="checkbox"/> Membranrohrmodule |
| <input type="checkbox"/> Sewage Sludge Filters | <input type="checkbox"/> Klärschlammfilter | <input type="checkbox"/> Tubular Filters | <input type="checkbox"/> Röhrenfilter |
| <input type="checkbox"/> Sewing Units Filter Bags | <input type="checkbox"/> Nähanlagen für Filterschläuche | <input type="checkbox"/> Ultrafiltration | <input type="checkbox"/> Ultrafiltration |
| <input type="checkbox"/> Sewing Units Filter Pockets | <input type="checkbox"/> Nähanlagen für Filtertaschen | <input type="checkbox"/> Ultrasonic Slitting/Cutting | <input type="checkbox"/> Ultraschallschneiden |
| <input type="checkbox"/> Sewing Units Liquid Filtration | <input type="checkbox"/> Nähanlagen für Flüssigkeitsfilter | <input type="checkbox"/> Ultrasonic Welding | <input type="checkbox"/> Ultraschallverschweißen |
| <input type="checkbox"/> Sieves | <input type="checkbox"/> Siebe | <input type="checkbox"/> Unit Collectors, Dust | <input type="checkbox"/> Abscheidereinheit, Staub |
| <input type="checkbox"/> Simulation | <input type="checkbox"/> Simulation | <input type="checkbox"/> Vacuum Disc Filters | <input type="checkbox"/> Vakuumscheibenfilter |
| <input type="checkbox"/> Slitter | <input type="checkbox"/> Längsschneider | <input type="checkbox"/> Vacuum Drum Filters | <input type="checkbox"/> Vakuumentrommelfilter |
| <input type="checkbox"/> Slitting Tools | <input type="checkbox"/> Schneidwerkzeuge | <input type="checkbox"/> Vacuum Filters | <input type="checkbox"/> Vakuumfilter |
| <input type="checkbox"/> Sludge Dewatering | <input type="checkbox"/> Schlammentwässerung | <input type="checkbox"/> Vacuum Pumps | <input type="checkbox"/> Vakuumpumpen |
| <input type="checkbox"/> Special Machinery Filtration Industry | <input type="checkbox"/> Spezialmaschinen Filtrationsindustrie | <input type="checkbox"/> Valves | <input type="checkbox"/> Ventile |
| <input type="checkbox"/> Special Machinery Textile Industry | <input type="checkbox"/> Spezialmaschinen Textilindustrie | <input type="checkbox"/> Waste Water Filters | <input type="checkbox"/> Abwasserfilter |
| <input type="checkbox"/> Spiral Dewatering | <input type="checkbox"/> Spiralentwässerung | <input type="checkbox"/> Water Filters | <input type="checkbox"/> Wasserfilter |
| <input type="checkbox"/> Stainless Steel Filters | <input type="checkbox"/> Edelstahlfilter | <input type="checkbox"/> Water Filter Testing | <input type="checkbox"/> Wasserfilterprüfung |
| <input type="checkbox"/> Strainers | <input type="checkbox"/> Feinsiebe | <input type="checkbox"/> Wettability Analysis | <input type="checkbox"/> Benetzungsanalyse |
| <input type="checkbox"/> Surface Analysers | <input type="checkbox"/> Oberflächenanalysegeräte | <input type="checkbox"/> Wire Mesh Laminates, metal | <input type="checkbox"/> Gewebelaminat, Metall. |
| <input type="checkbox"/> Surface Cleaning | <input type="checkbox"/> Oberflächenreinigung | <input type="checkbox"/> Wire/Wovens | <input type="checkbox"/> Gewebe |
| <input type="checkbox"/> Surface Treatment | <input type="checkbox"/> Oberflächenbehandlung | <input type="checkbox"/> Wirecloth Filters | <input type="checkbox"/> Gewebefilter |
| | | <input type="checkbox"/> Zeta Potential Measurement | <input type="checkbox"/> Zetapotentialbestimmung |

Markets

Our products and/or services can be used in the following industries:

Number of market entries is limited to 10 keywords for each exhibitor

- | | | | |
|---|--|---|--|
| <input type="checkbox"/> Aerospace Industry | <input type="checkbox"/> Luft- und Raumfahrtindustrie | <input type="checkbox"/> Metal Processing Industry | <input type="checkbox"/> Metallverarbeitende Industrie |
| <input type="checkbox"/> Agriculture | <input type="checkbox"/> Agrarwirtschaft | <input type="checkbox"/> Mineral / Oil / Gas Production | <input type="checkbox"/> Mineralöl/Öl/Gasproduktion |
| <input type="checkbox"/> Automotive Industry | <input type="checkbox"/> Automobilindustrie | <input type="checkbox"/> Mining Industry | <input type="checkbox"/> Bergbauindustrie |
| <input type="checkbox"/> Biotechnology/Biopharmac. Ind. | <input type="checkbox"/> Biotechnologie/Biopharmazie | <input type="checkbox"/> Paint, Pigments, Coatings Industry | <input type="checkbox"/> Farben-, Pigment-, Beschichtungsindustrie |
| <input type="checkbox"/> Building & Construction Services | <input type="checkbox"/> Bauindustrie | <input type="checkbox"/> Petrochemical Industry | <input type="checkbox"/> Petrochemische Industrie |
| <input type="checkbox"/> Ceramic, Glass Industry | <input type="checkbox"/> Keramik-, Glasindustrie | <input type="checkbox"/> Pharmaceutical Industry | <input type="checkbox"/> Pharmazeutische Industrie |
| <input type="checkbox"/> Chemical Industries | <input type="checkbox"/> Chemische Industrie | <input type="checkbox"/> Plastic Industry | <input type="checkbox"/> Kunststoffverarbeitende Industrie |
| <input type="checkbox"/> Dairy Industry | <input type="checkbox"/> Milchindustrie / Molkerei | <input type="checkbox"/> Plating Industry | <input type="checkbox"/> Oberflächentechnik |
| <input type="checkbox"/> Electronic, Microelectronic Industry | <input type="checkbox"/> Elektronik-, Mikroelektronikind. | <input type="checkbox"/> Printing Industry | <input type="checkbox"/> Druckindustrie |
| <input type="checkbox"/> Energy, Energy Supply | <input type="checkbox"/> Energieerzeugung,-versorgung | <input type="checkbox"/> Pulp, Paper Industry | <input type="checkbox"/> Zellstoff-, Papierindustrie |
| <input type="checkbox"/> Environmental Protection | <input type="checkbox"/> Umweltschutz | <input type="checkbox"/> Semiconductor Industry | <input type="checkbox"/> Halbleiterindustrie |
| <input type="checkbox"/> Filtration and Separation Industry | <input type="checkbox"/> Filtrations- und Separationsindustrie | <input type="checkbox"/> Textile Industry | <input type="checkbox"/> Textilindustrie |
| <input type="checkbox"/> Food, Beverage Industry | <input type="checkbox"/> Lebensmittel-, Getränkeindustrie | <input type="checkbox"/> Waste Treatment | <input type="checkbox"/> Abfallwirtschaft |
| <input type="checkbox"/> Heavy Industry | <input type="checkbox"/> Schwerindustrie | <input type="checkbox"/> Waste Water Treatment | <input type="checkbox"/> Abwasserwirtschaft |
| <input type="checkbox"/> Iron, Steel Manufacturing | <input type="checkbox"/> Eisen-, Stahlherstellung | <input type="checkbox"/> Water Treatment, Supply | <input type="checkbox"/> Wasserbehandlung, -versorgung |
| <input type="checkbox"/> Medical, Health Care Industry | <input type="checkbox"/> Medizintechnik, Health Care Industrie | <input type="checkbox"/> Wood-processing Industry | <input type="checkbox"/> Holzverarbeitende Industrie |

Please return all 3 pages to:
Fax: +49 (0)2132 93 57 62

Filtech Exhibitions Germany
PO Box 12 25
40637 Meerbusch – Germany

FILTECH 2013

October 22-24, 2013
Wiesbaden · Germany

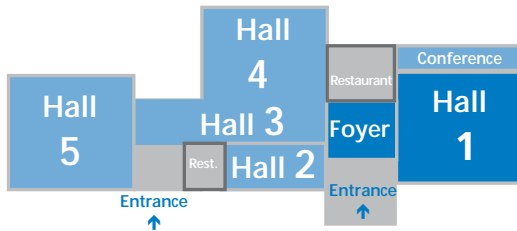

Hall 1

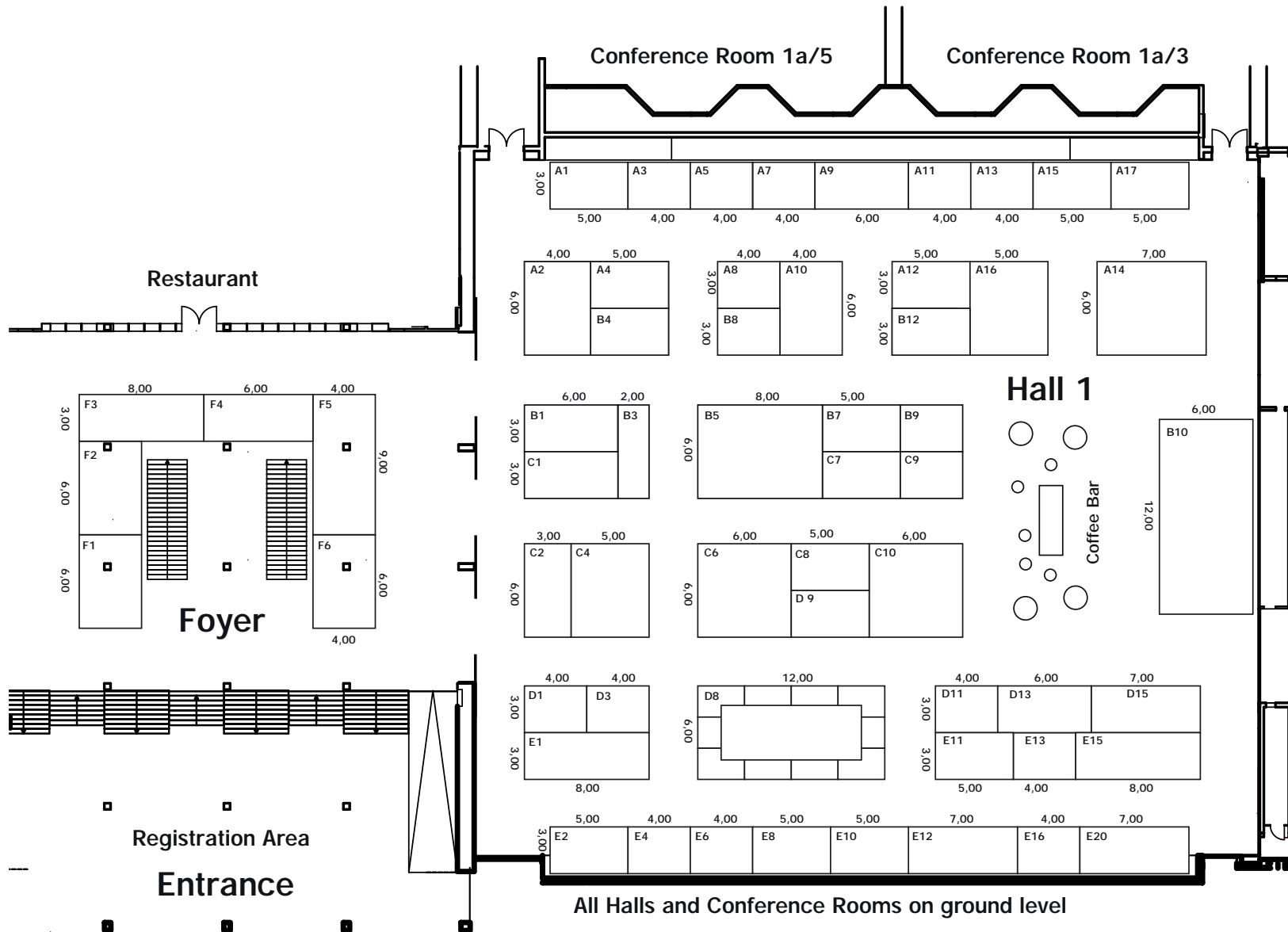

FILTECH 2013

October 22-24, 2013
Wiesbaden · Germany

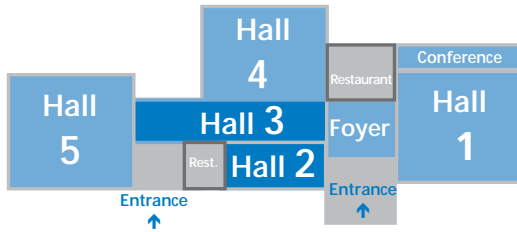

Hall 2/3

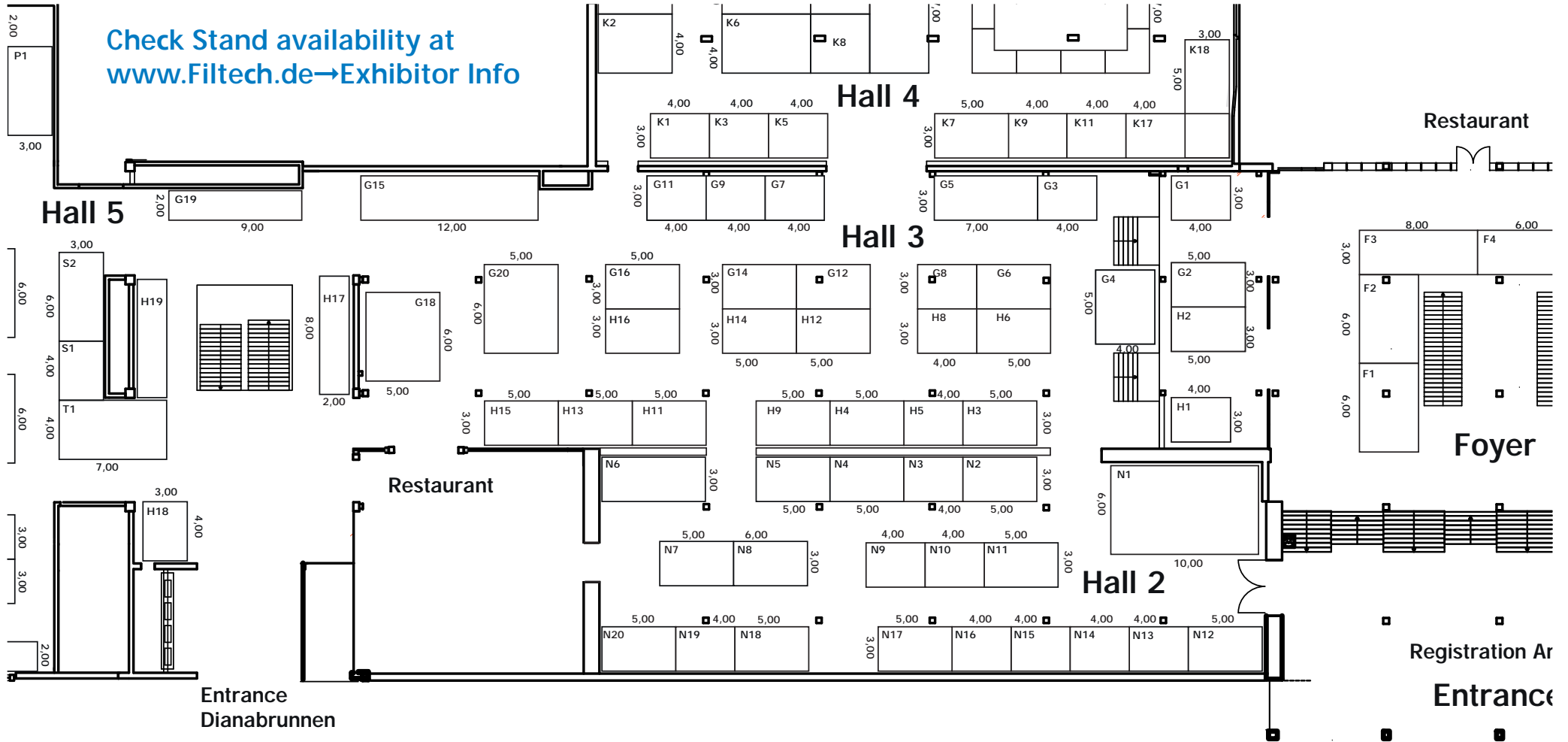

Registration Area
Entrance

FILTECH 2013

October 22 – 24, 2013
Wiesbaden · Germany

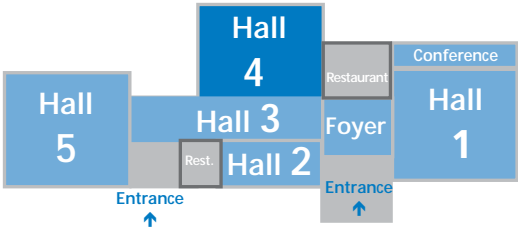

Hall 4

Check Stand availability at www.Filtech.de → Exhibitor Info

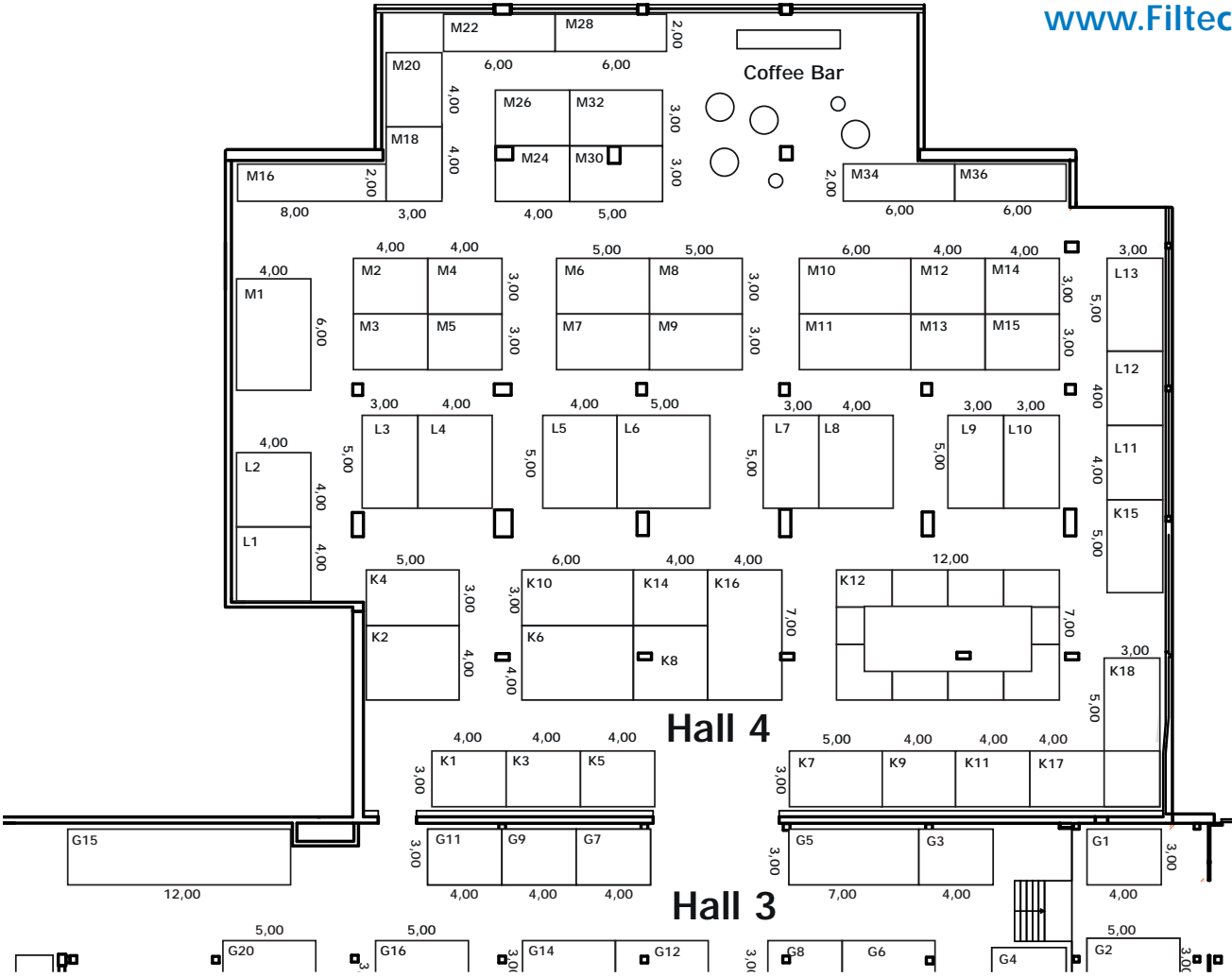

FILTECH 2013

October 22 – 24, 2013
Wiesbaden · Germany

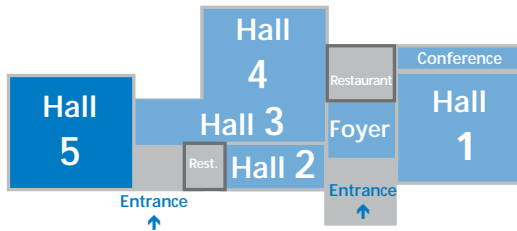

Hall 5

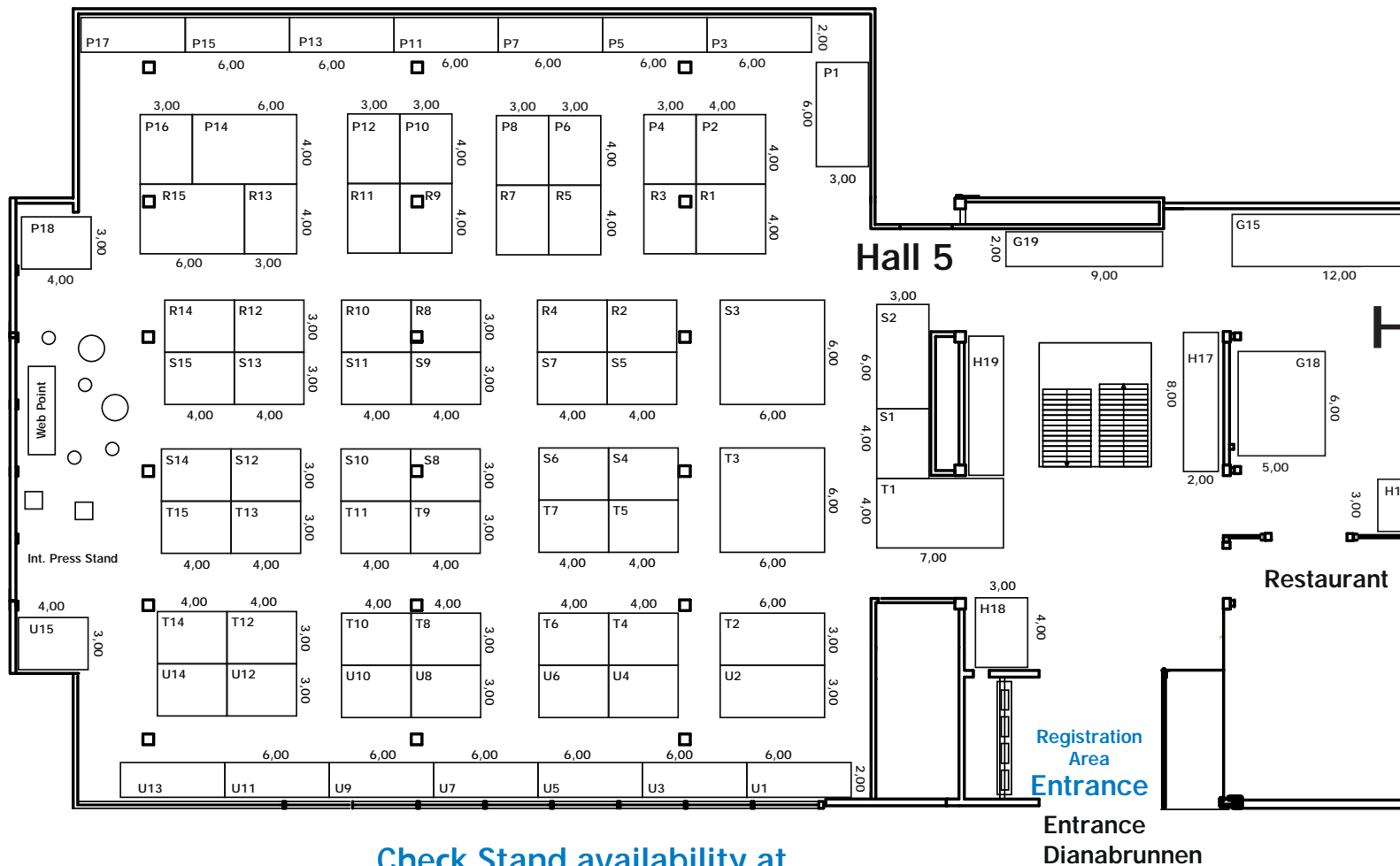

Check Stand availability at
www.Filtech.de → Exhibitor Info



APPLICATION FOR CO-EXHIBITORS

1D Return to:
Filtech Exhibitions Germany
PO Box 12 25
40637 Meerbusch – Germany
Fax: +49 (0)2132 93 57 62

APPLICATION FOR CO-EXHIBITORS

MAIN EXHIBITOR:

Stand no. _____ Applied for / already allotted

Company Name

Street/PO Box

Post Code/City

Country

Contact Person

E-mail

Phone/Fax

HEREWITH WE ADVISE THE FOLLOWING CO-EXHIBITOR/S:

Company Name

VAT Registration No.

Street/PO Box

Post Code/City

Country

Contact Person

E-mail

Phone/Fax

Important:

By returning this form the Main-Exhibitor agrees to pay a fee of EUR 275 Euro plus VAT for each Co-Exhibitor. These prices are exclusive of VAT – VAT liability is transferred to the recipient of the service according to the reverse charge system. EU VAT Directive 2006/112/EC. VAT will be charged at current rate.

This fee includes the participation fee, print communication and online communication for the Co-Exhibitor. Without the prior consent of the Organizer, Exhibitors are not permitted to sublet their allotted stand either fully or in part to a third party. All accounts will be sent to the Main-Exhibitor, who still remains responsible. Other correspondence will be sent to the co-exhibitor. Consented Co-Exhibitors are entitled to: free Catalogue entry incl. address, text entry & 4c Company logo, product index listing plus Company logo & text entry at FILTECH homepage

Place / Date

Company stamp / Signature



APPLICATION FOR EXHIBITOR PASSES

1E

Company: _____

Stand No.: _____

Return to:

Filtech Exhibitions Germany
PO Box 12 25
40637 Meerbusch – Germany

Street: _____

Postcode/Town: _____

Phone: _____

Fax: _____

Fax: +49 (0)2132 93 57 62

Phone: +49 (0)2132 93 57 60

Contact Person: _____

Mr. Mrs.

FREE SERVICE

WE ORDER THE FOLLOWING EXHIBITOR PASSES FOR OUR STAFF:

1. Mr Mrs., First Name

Last Name

Position

Based in (City):

2. Mr Mrs., First Name

Last Name

Position

Based in (City):

3. Mr Mrs., First Name

Last Name

Position

Based in (City):

4. Mr Mrs., First Name

Last Name

Position

Based in (City):

5. Mr Mrs., First Name

Last Name

Position

Based in (City):

During building-up and dismantling periods no passes are required. Exhibitor passes are available from October 22, 2013 on in the entrance hall. Further passes available upon request.

International Conference & Exhibition

October 22 – 24, 2013

www.FILTECH.de

The Filtration Event

Wiesbaden · Germany

Catalogue Entry

1H

Please complete, and e-mail the document to info@filtech.de until **July 31, 2013**.

Please publish the following information in the FILTECH 2013 Catalogue:

FREE SERVICE

Stand number:

Company Name:

Street:

ZIP Code:

Town:

Country:

Contact Person:

Phone:

Fax:

E-mail:

Web:

The Catalogue entry includes a text entry with the Company profile and/or product information.

Please send **120 words in English or 60 words in English and German**.

In single cases the submitted text might exceed the 1 page entry. The organizer reserves the right to edit text entries.

List of Exhibitors	Stand
 ANDRITZ KMPT ANDRITZ KMPT GmbH Industriestrasse 1-3 85256 Vierkirchen Germany contact: Andreas Häussner phone: +49 8139 80 29 91 16 fax: +49 8139 80 29 91 50 e-mail: kmpt@andritz.com web: www.kmpt.com ANDRITZ KMPT manufactures innovative key technologies for effective mechanical and thermal solid/liquid separation. Krauss-Maffei Centrifuges, Filters and Dryers set standards in the chemical, pharmaceutical and related industry ensuring quality and performance. ANDRITZ KMPT produziert innovative Schlüsseltechnologien für die erfolgreiche mechanische und thermische Fest-Flüssigtrennung. Unsere Krauss-Maffei Zentrifugen, Filter, Trockner und Systeme sind in der chemischen, pharmazeutischen und artverwandten Industrie für deren Qualität und Leistungsfähigkeit bekannt.	A14 HALL 1

28 FILTECH 2011 March 22 – 24, 2011 Wiesbaden

Please type your text entry here:

Important Note: Please do not fax this document but complete the pdf form and e-mail it back to info@filtech.de

The organizer will not retype and faxed entries. If you are unable to complete and e-mail this form please send a word document containing all information required and e-mail it to info@filtech.de with the Reference line: Catalogue Entry + Your Company Name

International Conference & Exhibition

October 22 – 24, 2013

www.FILTECH.de

The Filtration Event

Wiesbaden · Germany

RULES & REGULATIONS - FILTECH 2013

1. Organiser

Filtech Exhibitions Germany GmbH & Co. KG
PO Box 12 25 – 40637 Meerbusch – Germany
Phone: +49 (0)2132 93 57 60 Fax: +49 (0)2132 93 57 62
e-mail: info@Filtech.de Web: www.Filtech.de

2. Venue/Date

Rhein-Main-Hallen · Friedrich Ebert Allee · 65158 Wiesbaden
Date: October 22 – 24, 2013 from 9:00 am – 6:00 pm

3. Participation charges

The FILTECH 2013 net participation charges are 255 Euro per sq. m space only regardless of the type of space applied for. The minimum size is 12 sq. m. Pillars, columns and space for installation connections will all be included in space costs. The participation costs (space only) do not include stand partition walls. These prices are exclusive of VAT – VAT liability is transferred to the recipient of the service according to the reverse charge system. EU VAT Directive 2006/112/EC. VAT will be charged at current rate.

4. Terms of Payment

Upon receipt of the confirmation of the stand booking (admission) 40% is payable immediately without deduction. The remaining 60% is payable 5 months before the show at the latest. Invoices issued 5 months before the Show are payable immediately in full. Invoices for miscellaneous services or for supplies ordered separately should be settled by the date of the invoice. If the exhibitor gives instructions to render accounts to a third party, the exhibitor still remains responsible. Remittances should be endorsed with the invoice number, marked FILTECH 2013 and made out in favour of the organiser and paid into the following bank account: Deutsche Bank Düsseldorf – Bank Code 300 700 24 – Account-No. 881 6688 00 IBAN: DE08300700240881668800 – BIC/SWIFT: DEUTDE33HAN30 In the case of late payment, interest will be charged at a rate of 2% above the base rate of the European Federal Bank effective at the time. If payment of the invoices is not effected by the exhibitor within the stipulated periods, the organizer shall have the right (also in the event of space not fully paid for) to withdraw from the contract with regard to all space rented by the exhibitor and to dispose of this space otherwise.

5. Application for space

Applications for space shall be made by using the official form, acknowledging the Conditions of Participation and the Technical Regulations to be issued subsequently. Officially signed application forms should be sent to the organiser. Applications made subject to conditions or reservations cannot be taken into consideration. Every endeavour will be made to make requests for specific sites, but such requests cannot be recognised as a condition for participation. No undertaking can be given with respect to exclusion of competitors. The application will be considered effected once it has been received by the organiser and it is then binding until admission. Receipt of application will be acknowledged in writing. For both exhibitors and stand contractors the Technical Regulations constitute an integral part of the contract. These are available on request, subject to subsequent modifications, and become binding for the event.

6. Admission

Only products which meet the subject of the Event can be admitted and exhibited. A legal claim for admission does not exist. Exhibitors who have not fulfilled their financial obligations to the organiser or have contravened the conditions of participation or legal requirements can be excluded from participation. Exhibitors will receive written confirmation that they have been admitted. This confirmation applies only to the designated exhibitor. Notification of admission constitutes the conclusion of the contract between the organiser and the applicant.

If the allotted space is not available for reasons beyond the control of the organiser the exhibitor may claim a refund of the space rental cost; there will be no claims for damage. The organiser may, if required by circumstances and specifying its reasons for doing so, and bearing in mind what is reasonable for the exhibitor, deviate from the notice of admission by allocating space in another position or reducing or increasing the stand size. The organiser reserves the right to alter the hall layout without prior notice to exhibitors.

7. Obligations of Acceptance

For the duration of the contract, the exhibitor is obliged to use the stand in accordance with the General Conditions of Participation and to ensure that sufficient personnel is on the stand during the opening hours of the event. Stand dismantling prior to the end of the Show is not permitted and constitutes a cancellation of the contract. If an exhibitor cancels the contract the organizer is entitled to demand a lump sum compensation from the exhibitor which equals the price of participation.

8. Stand Design

The stand sides facing the visitor aisles must be designed in a transparent and open form. For each stand side facing the visitor aisles, a maximum of 50% of the stand length may be built with closed elements, to a height of 2.50 m. There must be no hindrance to opposite or adjacent stands, and no impairment of the view into those stands. Any stand concepts which are not confirm to these rules must be submitted for approval to the organizer 3 months before the Show and require the approval of the organizer. Also stands concepts higher than 2.5 meters must be advised to the Organizer for approval as the maximum height varies with the hall/stand position. Please send stand layout drawing when planning your stand concept.

9. Exhibits

Exhibits may not be removed from the stand until after the event has ended. Selling from the stand prior to the end of the show is not permitted. The operation of machines and their weight have to be indicated to the organiser prior to the show. Especially as the loading-bearing capacity of hall floors varies with the hall/stand position.

10. Co-exhibitors

A fee of EUR 275 Euro is due for assigned Co-Exhibitors. This fee includes the participation fee, print communication and online communication for the Co-Exhibitor. Without the prior consent of the Organizer, Exhibitors are not permitted to sublet their allotted stand either fully or in part to a third party. All accounts will be sent to the Main-Exhibitor, who still remains responsible. Other correspondence will be sent to the coexhibitor. Consented Co-Exhibitors are entitled to: free Catalogue entry incl. address, text entry & 4c Company logo, product index listing plus Company logo & text entry at FILTECH website.

11. Communication Package / Invited Guest Tickets

Each exhibitor receives a free entry in the Exhibition Catalogue incl. address, 4c Company logo, Company description (German & English) product index & market index listing. Free entry at FILTECH website incl. Company description (German & English), 4c Company logo, product index & market index listing, free publication of Exhibitor news/press releases). According to the stand size each exhibitor receives free "1-Day Guest Tickets" to invite clients and promotional stickers.

12. Cancellation and non-participation

Following admission (relevant: date of reservation confirmation issued by the organizer), the exhibitor shall not be entitled to rescind the contract nor to reduce the stand area. The participation charges shall be payable in full together with any costs actually entailed. Should the organiser make alternative use of unoccupied areas to improve the general appearance of the show, the exhibitor who reserved the space shall not be released from his financial obligations. The organiser is free to alter the hall layout, without prior notice to exhibitors. The cancellation and non-participation of a main exhibitor automatically results in the exclusion and cancellation of admission for the co-exhibitor. If settlement or bankruptcy proceedings are pending against an exhibitor's assets, or if such proceedings have been suspended due to inadequate assets, the organiser shall be entitled to cancel the contract without further notice. The exhibitor must inform the organiser immediately and under any circumstances when such settlement or bankruptcy proceedings have been proposed. The above mentioned paragraphs apply accordingly.

13. Exhibition insurance cover and exclusion of liability

Every exhibitor exhibits at his own risk. Exhibitors can obtain cover, at their own expense, for risks during participation at the event. The organiser accepts no responsibility for exhibits as well as stand fitments and expressly excludes all liability for any loss or damage. This exclusion of liability is in no way limited by the security services provided by the organiser. Furthermore the organiser is only liable in cases of gross negligence or wilful intent. The organiser is insured to cover his statutory liability. In other respects the General Insurance Conditions for Liability Insurances (AHB) shall apply.

14. Environmental protection: Eco- and Energy flat

9,10 € per sq m (plus German VAT) will be charged to cover the rising costs for energy, waste disposal and recycling. The eco- and energy flat is charged together with the deposit invoice. Still exhibitors and their contractors remain responsible for the proper and environmentally acceptable disposal of all waste that is produced during the fair and during build-up and dismantling of the stand. Exhibitors are also obliged to ensure that all their contractors/stand builders leave no materials behind when leaving the stand. Any materials left behind will be disposed of without verification of their value and at the exhibitor's expense, a higher charge being payable.

15. Reservation of rights and final conditions

The organiser has the right to postpone, curtail, extend, temporarily close, in part or completely, or cancel the trade fair, should it be necessary, for reasons beyond their control, and whilst considering the interests of the exhibitors in carrying it out. In such justifiable, exceptional circumstances, as in all cases of force majeure, exhibitors shall not be entitled to rescind their contract, claim damages nor reduction of participation charges. If the event does not take place for the afore-mentioned reasons, exhibitors may be charged up to 25% of the participation charges to cover general costs. A larger amount can be demanded from individual exhibitors if they have given instructions for extra work to be carried out on their behalf. If the organiser is responsible for the cancellation of the event, no participation charges will be payable. The organiser will entertain no claim for damages. All verbal agreements, individual approvals and special arrangements must be confirmed in writing by the organiser. Whenever admission documents contain the reference that they have been drawn up by the organiser by computer, even if they contain no signature, they are legally binding.

All claims by exhibitors against the organiser must be made within 6 months. Claims made there after will not be valid. The period of limitation starts at the end of the month in which the event finished. The place of performance and jurisdiction for all mutual obligations is Meerbusch or, at the request of the organiser, the jurisdiction of the exhibitor's place of business. This also applies to complaints arising from cheques or drafts. The law of the Federal Republic of Germany is applicable. The German text is binding.